



## SERIES A20-62 ROLLER DIA.114 BEARING 6204

### 3 ROLL OFFSET TROUGH IDLERS

MAX. BELT SPEED 4.5 m/s  
BEARING RATING 1300 kg

BROACHING PLAIN 14.3 A/F

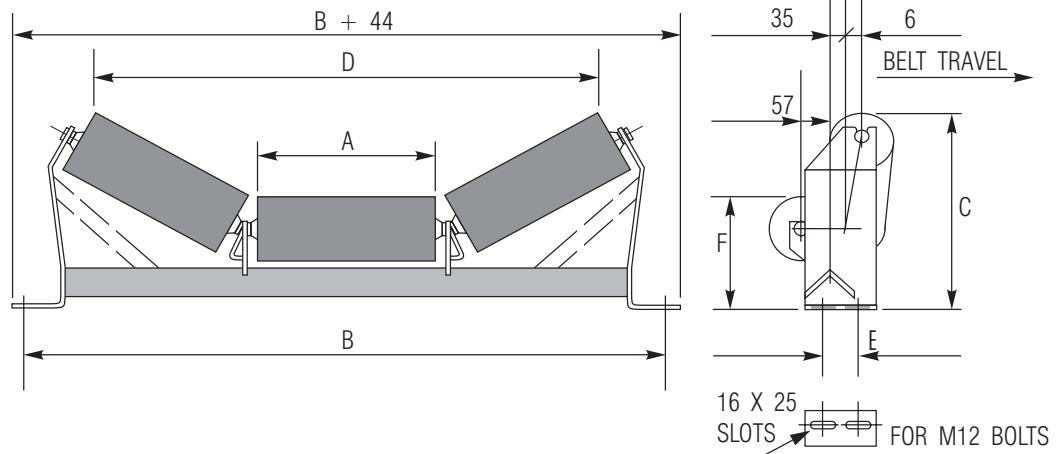

		IDLER DIMENSIONS mm												
BELT WIDTH	A	B	20°		30°		35°		45°		E	F	ANGLE SIZE	SHAFT DIA
			C	D	C	D	C	D	C	D				
400	154	650	231	498	256	435	266	412	289	386	56	176	65	24
450	172	700	237	550	265	484	276	459	302	429	56	176	65	24
500	189	750	243	599	273	531	286	504	314	470	56	176	65	24
600	224	850	255	700	291	626	306	596	339	555	56	176	65	24
650	244	900	262	757	301	681	317	649	353	603	56	176	65	24
750	278	1000	274	855	318	774	337	739	377	685	56	176	65	24
800	294	1050	279	901	326	818	346	781	388	724	56	176	65	24
900	331	1150	292	1008	344	919	367	879	415	813	56	176	75	24
1000	358	1250	301	1086	358	993	383	950	434	878	56	176	75	24
1050	383	1300	309	1158	370	1061	397	1016	451	939	56	176	75	24
1200	436	1450	328	1310	397	1206	428	1156	489	1067	56	176	75	24

BELT WIDTH	IDLER SETS MASSES			
	PLAIN		IMPACT	
	MRP	TOTAL	MRP	TOTAL
400	6.6	16.4		
450	7.2	17.4		
500	7.7	18.4		
600	8.7	20.5		
650	9.3	21.6		
750	10.3	24.9		
800	10.7	26.0		
900	11.8	28.2		
1000	12.6	31.2		
1050	13.4	32.7		
1200	14.9	36.1		

UNIT MASSES		
FRAME	MASS 1 ROLL	
ONLY	PLAIN	IMPACT
7.1	3.1	
7.5	3.3	
7.8	3.6	
8.4	4.0	
8.8	4.3	
10.7	4.7	
11.1	5.0	
11.9	5.4	
13.7	5.8	
14.2	6.1	
15.6	6.8	



## SERIES A25-62 ROLLER DIA.114 BEARING 6205

### 3 ROLL OFFSET TROUGH/IMPACT IDLERS

MAX. BELT SPEED 4.5 m/s

BROACHING PLAIN 14.3 A/F

BEARING RATING 1430 kg

BROACHING IMPACT 14.3 A/F

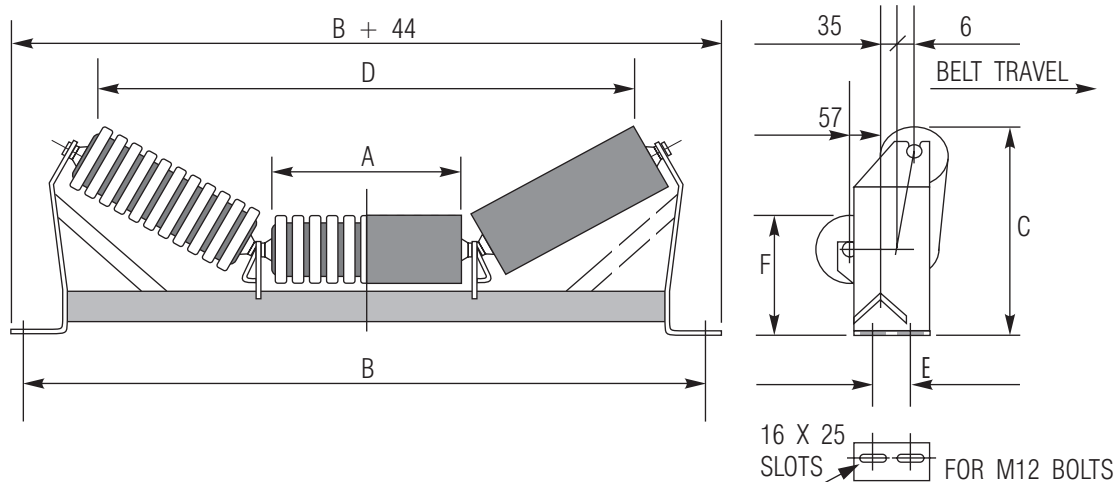

		IDLER DIMENSIONS mm												
BELT WIDTH	A	B	20°		30°		35°		45°		E	F	ANGLE SIZE	SHAFT DIA
			C	D	C	D	C	D	C	D				
400	154	650	234	497	259	433	268	410	291	382	56	179	65	27
450	172	700	240	549	268	482	278	457	304	426	56	179	65	27
500	189	750	246	598	276	528	288	502	316	467	56	179	65	27
600	224	850	258	698	294	624	308	594	341	551	56	179	65	27
650	244	900	265	756	304	679	319	647	355	600	56	179	65	27
750	278	1000	277	854	321	771	339	737	379	682	56	179	65	27
800	294	1050	282	900	329	815	348	779	390	720	56	179	65	27
900	331	1150	295	1006	347	916	369	877	417	810	56	179	75	27
1000	358	1250	304	1084	361	990	385	948	436	875	56	179	75	27
1050	383	1300	312	1156	373	1058	399	1014	453	935	56	179	75	27
1200	436	1450	331	1309	400	1203	430	1154	491	1063	56	179	75	27

BELT WIDTH	IDLER SETS MASSES			
	PLAIN		IMPACT	
	MRP	TOTAL	MRP	TOTAL
400	6.9	17.4	7.0	17.6
450	7.4	18.5	7.4	18.5
500	7.9	19.5	8.3	19.9
600	9.0	21.7	9.5	22.3
650	9.5	22.9	10.4	23.9
750	10.5	26.3	12.2	28.0
800	11.0	27.4	12.5	28.9
900	12.1	29.8	14.3	32.0
1000	12.9	32.8	15.4	35.3
1050	13.6	34.3	16.4	37.2
1200	15.2	37.9	18.6	41.4

UNIT MASSES		
FRAME ONLY	MASS 1 ROLL	
	PLAIN	IMPACT
7.2	3.4	3.5
7.5	3.7	3.7
7.8	3.9	4.0
8.5	4.4	4.6
8.8	4.7	5.0
10.7	5.2	5.7
11.1	5.4	5.9
11.9	5.9	6.7
13.8	6.3	7.2
14.3	6.7	7.6
15.6	7.4	8.6



# **SERIES B20-62 ROLLER DIA.127 BEARING 6204** **3 ROLL OFFSET TROUGH IDLERS**

**MAX. BELT SPEED 5 m/s**  
**BEARING RATING 1300 kg**

**BROACHING PLAIN 14.3 A/F**

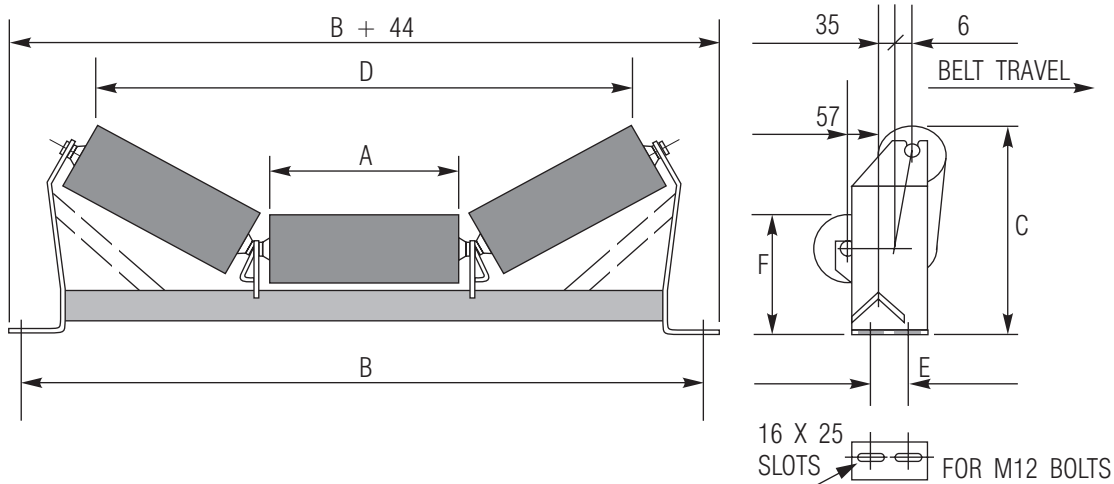

		IDLER DIMENSIONS mm												
BELT WIDTH	A	B	20°		30°		35°		45°		E	F	ANGLE SIZE	SHAFT DIA
			C	D	C	D	C	D	C	D				
400	154	650	238	494	262	429	271	405	294	377	56	183	65	24
450	172	700	244	546	271	478	281	452	307	420	56	183	65	24
500	189	750	250	595	279	524	291	497	319	461	56	183	65	24
600	224	850	262	696	297	620	311	589	344	546	56	183	65	24
650	244	900	269	753	307	675	322	642	358	594	56	183	65	24
750	278	1000	281	851	324	768	342	732	382	676	56	183	65	24
800	294	1050	286	897	332	811	351	774	393	715	56	183	65	24
900	331	1150	299	1004	350	912	372	872	420	804	56	183	75	24
1000	358	1250	308	1082	364	986	388	943	439	869	56	183	75	24
1050	383	1300	316	1154	376	1054	402	1009	456	930	56	183	75	24
1200	436	1450	335	1306	403	1199	433	1149	494	1058	56	183	75	24

BELT WIDTH	IDLER SETS MASSES			
	PLAIN		IMPACT	
	MRP	TOTAL	MRP	TOTAL
400	7.4	17.2		
450	8.0	18.3		
500	8.6	19.4		
600	9.7	21.6		
650	10.4	22.8		
750	11.5	26.2		
800	12.0	27.3		
900	13.2	29.7		
1000	14.1	32.7		
1050	15.0	34.3		
1200	16.7	38.0		

UNIT MASSES		
FRAME ONLY	MASS 1 ROLL	
	PLAIN	IMPACT
7.2	3.3	
7.5	3.6	
7.8	3.8	
8.5	4.4	
8.8	4.6	
10.8	5.1	
11.2	5.4	
12.0	5.9	
13.8	6.3	
14.3	6.7	
15.6	7.4	



**SERIES A25-62/82 ROLLER DIA.114 BEARING 6205**  
**SERIES A30-62/82 ROLLER DIA.114 BEARING 6206**

## FLAT RETURN & CARRY IDLERS

**BROACHING PLAIN 14.3 A/F**

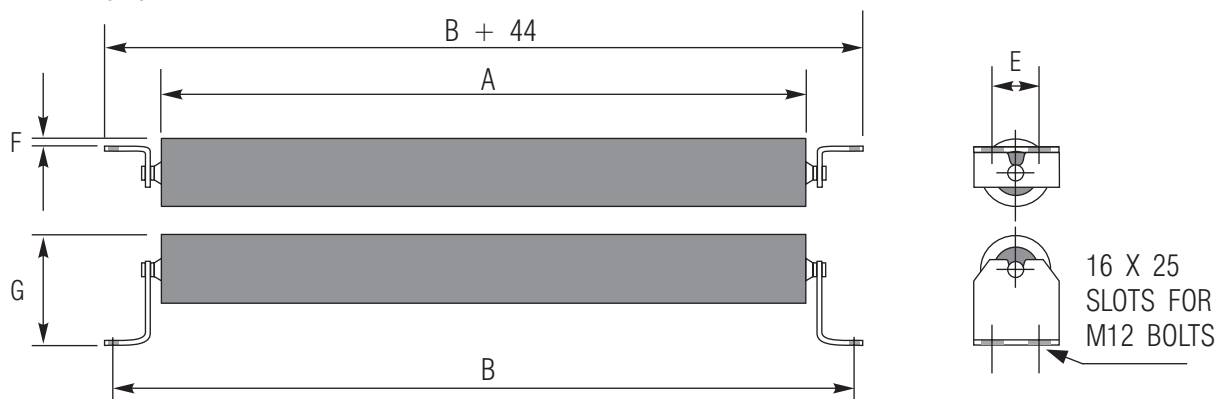

### SERIES A25 62/82

**ROLLER DIA.114**

**BEARING RATING 1430 kg**

**MAX. BELT SPEED 4.5 m/s**

BELT WIDTH	IDLER DIMENSIONS mm					SHAFT DIA.
	A	B	E	F	G	
400	494	650	56	16	150	27
450	544	700	56	16	150	27
500	594	750	56	16	150	27
600	694	850	56	16	150	27
650	744	900	56	16	150	27
750	844	1000	56	16	150	27
800	894	1050	56	16	150	27
900	994	1150	56	16	150	27
1000	1094	1250	56	16	150	27
1050	1144	1300	56	16	150	30
1200	1294	1450	56	16	150	30
1350	1494	1650	56	16	150	33
1400	1544	1700	56	16	150	33

IDLER MASSES			
SETS		BRKT.	ROLL
MRP	TOTAL	PAIR	PLAIN
5.6	9.8	1.5	8.3
6.1	10.5	1.5	9.0
6.6	11.2	1.5	9.7
7.6	12.6	1.5	11.1
8.1	13.4	1.5	11.9
9.1	14.8	1.5	13.3
9.6	15.5	1.5	14.0
10.6	16.9	1.5	15.4
11.5	18.4	1.5	16.9
12.0	20.3	1.5	18.8
13.5	22.7	1.5	21.2
15.5	26.9	1.5	25.4
16.0	27.7	1.5	26.2

### SERIES A30 62/82

**ROLLER DIA.114**

**BEARING RATING 1980 kg**

**MAX. BELT SPEED 4.5 m/s**

BELT WIDTH	IDLER DIMENSIONS mm					SHAFT DIA.
	A	B	E	F	G	
400	494	650	56	18	152	27
450	544	700	56	18	152	27
500	594	750	56	18	152	27
600	694	850	56	18	152	27
650	744	900	56	18	152	27
750	844	1000	56	18	152	27
800	894	1050	56	18	152	27
900	994	1150	56	18	152	27
1000	1094	1250	56	18	152	27
1050	1144	1300	56	18	152	30
1200	1294	1450	56	18	152	30
1350	1494	1650	56	18	152	33
1400	1544	1700	56	18	152	33
1500	1644	1800	56	18	152	36

IDLER MASSES			
SETS		BRKT.	ROLL
MRP	TOTAL	PAIR	PLAIN
5.9	11.1	1.5	9.6
6.4	11.9	1.5	10.4
6.9	12.7	1.5	11.2
7.9	14.4	1.5	12.9
8.4	15.2	1.5	13.7
9.4	16.8	1.5	15.3
9.8	17.6	1.5	16.1
10.8	19.2	1.5	17.7
11.8	20.8	1.5	19.3
12.3	21.6	1.5	20.1
13.8	24.0	1.5	22.5
15.7	27.3	1.5	25.8
16.2	28.1	1.5	26.6
17.2	32.5	1.5	31.0